

Shiawassee- EMAA Camping Reservation Form

Name: _____ Date: _____

Phone: _____ Email: _____

Back Number(s): _____

Days Planned to Camp (Please circle): Thursday at 2pm Friday 2pm-Sunday

Estimated Arrival time (Day and Time): _____

--Please see the attached camping map for Shiawassee County Fairgrounds to complete the following information--

Preferred Camping Spot (Please pick 3): _____

Preferred Camping with: _____

Slides Location: _____ Door Location: _____

Important Information

- Any camping boxes that are cut or used while locked **will** result in a large fine from the fairgrounds.
- Reserved Camping spots are first come first serve. There are no guarantees on your requested location.
- Camping Reservations will no longer be taken after the Saturday before the show. o If you forget to reserve, you will be assigned a Non-Reserved Spot in the designated location by Zara or Office Staff. These sites have an additional \$10 non-reserved fee.

Please email this form the Zara Wright at emaa.camping@gmail.com or mail it to:

8559 Lovejoy Rd. Byron, MI 48418

Lots 1-7 are above Lot 8

8
9
10
11
12
13
14
15
16
17
18
19
20
21
22
23
24
25
26
27
28
29
30
31
32
33
34
35
36
37
38
39
40
41
42
43
44
45
46
47
48
49
50

DRIVEWAY

DRIVEWAY

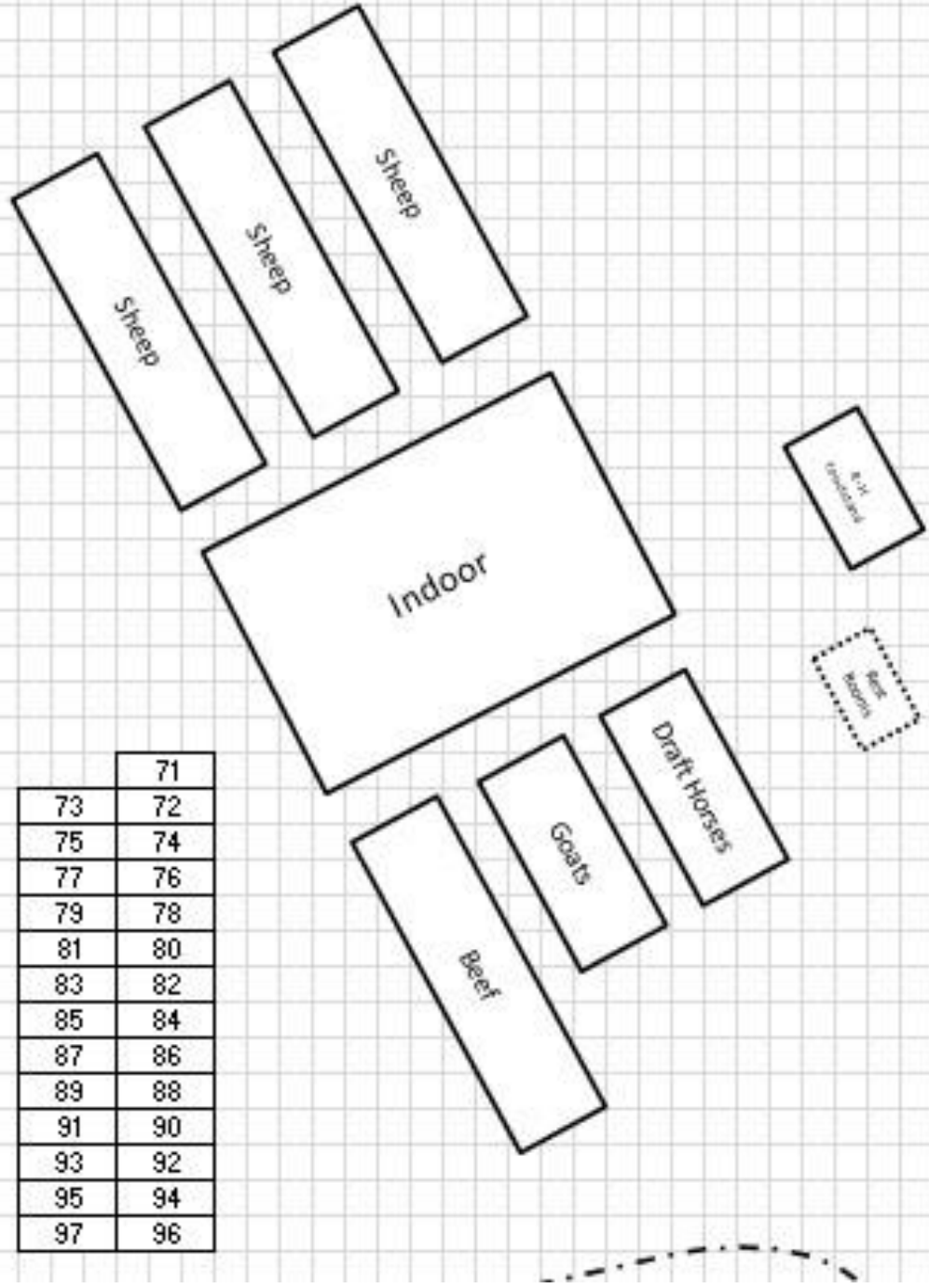

46
47
48
49
50
51
52
53
54
55
56
57
58
59
60
61
62
63
64

91	90
93	92
95	94
97	96

DRIVEWAY



65
66
67
68
69
70

DRIVEWAY

DRIVEWAY

DRIVEWAY

162	163
160	161
158	159
156	157
154	155
152	153
150	151
148	149
146	147
144	145
142	143
140	141
138	139
136	137
134	135
132	133
130	131
128	129
126	127
124	125
122	123
120	121
118	119
116	117
114	115
112	113
110	111
108	109
106	107
104	105
102	103
100	101

DRIVEWAY

DRIVEWAY

DRIVEWAY

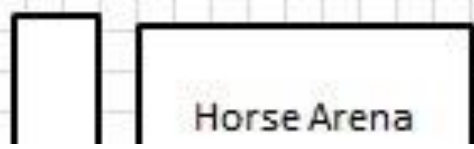

DRIVEWAY

PARKING

11T
9T
7T
5T
3T
1T